



**St Martins' Lane, Langley Park,  
Beckenham, BR3 3XU  
Price £610,000**

**Description:**

A stunning and much sought after Georgian style four bedroom end of terrace town house, arranged over three floors and offering an impressive 2004 sq ft of living space, set in this prestigious private development set within parkland and offering 24hr security.

On the ground floor is an impressive 17 ft kitchen diner with fully integrated appliances leading to a delightful conservatory onto the well kept west facing garden. The 1st floor comprises of a 17 Ft "L" shaped reception room with Juliette balcony overlooking the square and en-suite bedroom. The top floor offers 3 further bedrooms, one of which is ensuite and family bathroom.

Built just seven years ago the property occupies the premier plot within the square and is 1 of the 4 larger end of terrace houses.





FLOORPLANS

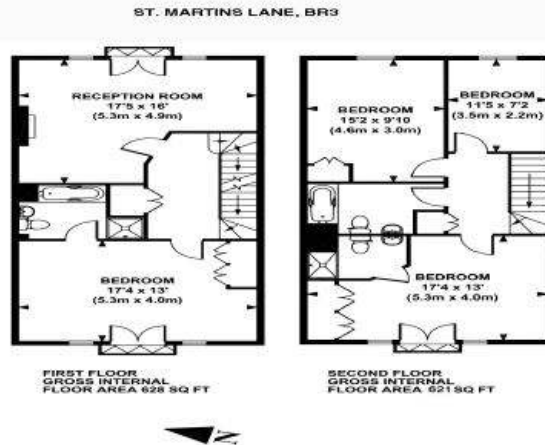

APPROX. GROSS INTERNAL FLOOR AREA 2004 SQ FT / 185 SQ M  
 Ref: P40888 Copyright Property Angels 2008  
 This floorplan is for illustration purposes and may not truly reflect design, or dimensions and should not be used for valuation or condition purposes.

ENERGY CHARTS

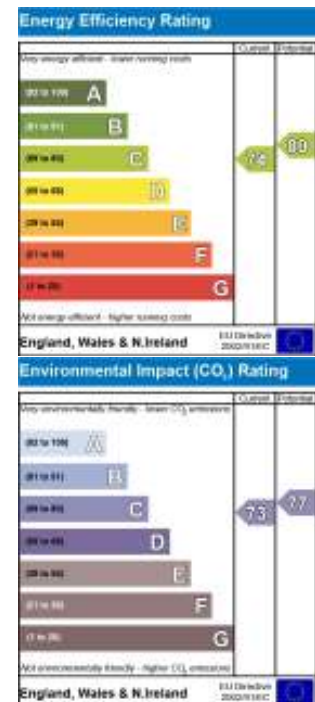

020 8663 4949  
 www.propertyangels.co.uk

Residential Sales and Lettings  
 team@propertyangels.co.uk